

SolarMax Energy Systems

How big a photovoltaic panel can the inverter support



Overview

How many solar panels can an inverter handle?

To effectively determine the number of solar panels an inverter can handle, you must first assess the size of your solar panel array. The overall capacity of your solar installation is defined by the wattage and number of panels. You can expect that the inverter should match or slightly exceed the combined wattage produced by the solar panels.

What size solar inverter do I Need?

A 4.5 kW array (or ten 450-watt solar panels) would just about cover your consumption. The type of solar panels you choose can also impact the size of the inverter you need. Different types of solar panels have different wattage ratings and efficiency levels. The three main types of solar panels are monocrystalline, polycrystalline, and thin film.

How many solar panels can a 5 kW inverter use?

You will also need to consider the wattage of the solar panels you plan to use. For example, if you have a 5 kW inverter and each of your solar panels is rated at 300 watts, you can calculate the maximum number of panels by dividing the inverter's capacity by the panel wattage: $5,000 \text{ watts (inverter)} / 300 \text{ watts (panel)} = \text{approximately } 16.67$.

Do solar inverters have a rated capacity?

Ratings on solar inverters often give the false impression that you can connect as many panels as you like, as long as you're under the stated power output. This leads to a misconception that exceeding the rated capacity is acceptable if you distribute loads wisely.

What happens if a solar inverter connects too many solar panels?

A: Connecting too many solar panels to a single inverter can lead to overloading, which can damage the inverter and result in decreased

efficiency. Overloading occurs when the total output of the solar panels exceeds the inverter's rated capacity, leading to overheating, shutdowns, and potential long-term failures.

What does a solar inverter do?

Solar inverters are one of the most important components of a solar panel system. They're responsible for converting direct current (DC) electricity from your solar panels to alternating current (AC) electricity to power your appliances.

How big a photovoltaic panel can the inverter support

18650 3.7V
Li-ion
RECHARGEABLE BATTERY
2000mAh



How many solar panels can an inverter handle

Inverter Capacity: The number of solar panels an inverter can handle is primarily determined by its power rating, usually measured in watts (W). **Panel Wattage:** Consider the ...

[Get a quote](#)

What size inverter is best for solar panels?

Conclusion You need to consider the solar panel power, conversion efficiency, battery voltage and future expansion needs when choosing the best size of the inverter. An ...



[Get a quote](#)

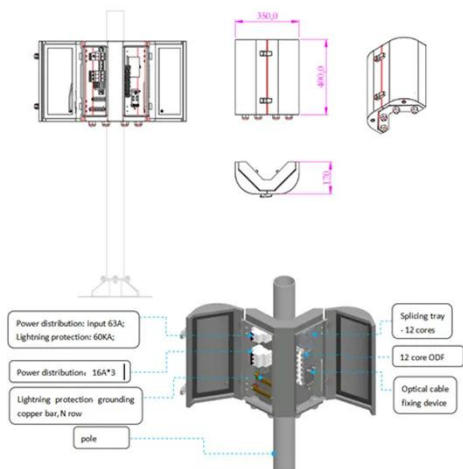

What Size Inverter Do I Need for a Solar Panel System?

Home solar inverters are typically sized between 1kW and 10kW, depending on the household's electricity needs and the total output power of ...

[Get a quote](#)

Inverter Size Calculator [Power

Inverter, AC, DC, ...

Calculate the ideal inverter size with the Inverter Size Calculator. Perfect for selecting inverters for homes, solar panels, or vehicles based on ...

[Get a quote](#)



Solar System Size Calculator: How Much Solar Do I Need?

Use our free solar system size calculator to estimate how much solar you need for your house. Quickly calculate how many solar panels you need.

[Get a quote](#)

Solar Panel Inverter Size Calculator: Know What You ...

Solar inverters come in different sizes, and you'll need to check the output of your solar energy system to find the perfect match. This guide can ...

[Get a quote](#)



How To Size A Solar Inverter in 3 Easy Steps

We explain the key concepts that determine solar inverter sizing including your power needs, the type and number

of solar panels you need, and the length of your wires.

[Get a quote](#)



Solar Panel Inverter Distance: How Far Can They Be from Your ...

When considering the solar panel inverter distance, one of the first things to remember is how far your inverter and battery are from the main electrical panel.

[Get a quote](#)



Solar Panel Inverter Size Calculator

For a 7kW solar system, you'll need an inverter of at least 7.5-8 kW. This size ensures it can handle your solar array's full output. It prevents power clipping and keeps ...

[Get a quote](#)

What Size Inverter Do I Need for a Solar Panel System?

Home solar inverters are typically sized

between 1kW and 10kW, depending on the household's electricity needs and the total output power of the solar panels.

[Get a quote](#)

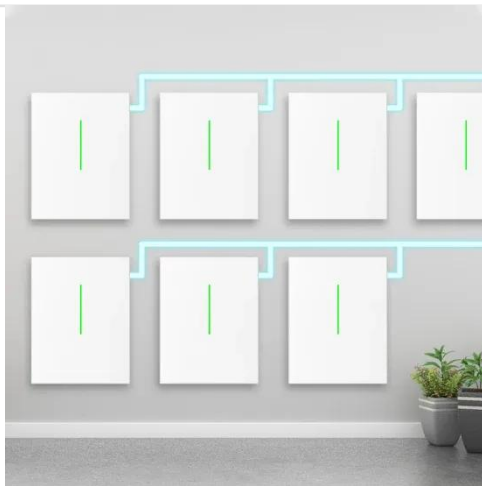

How many solar panels can an inverter handle

Inverter Capacity: The number of solar panels an inverter can handle is primarily determined by its power rating, usually measured in watts ...

[Get a quote](#)

Solar inverter size: Calculate the right size for your inverter

Inverters work most efficiently when operating near their maximum capacity and are typically sized to be roughly the same size as your solar panels. Inverters are usually sized lower than ...

[Get a quote](#)



How does sizing a solar inverter work?

Solar inverters come in all different sizes, big and small. Similar to solar panels, the size of an inverter can be

rated in watts (W). When it comes to solar inverter sizing, ...

[Get a quote](#)



Inverter Size Calculator - self2solar

Determining the correct inverter size depends on your solar array's capacity and your household's power needs. Generally, the inverter should be sized to match about ...

[Get a quote](#)



What Size Inverter Is Best for a 100W Solar Panel?

Final Thoughts on What Size Inverter is Best for a 100W Solar Panel At the end of this cable, inverter boxes play a big role in the capabilities of the solar panel system as a ...

[Get a quote](#)

Calculate Battery Size For Any Size Inverter (Using ...

To recharge your battery from time to time you would need the right size solar panel to do the job! Read the below

article to find out the suitable ...

[Get a quote](#)



Solar Panel Inverter Size Calculator: Know What You Need , Angi

Solar inverters come in different sizes, and you'll need to check the output of your solar energy system to find the perfect match. This guide can serve as a solar panel inverter ...

[Get a quote](#)

How Many Inverters Do I Need for Solar Panels? Find ...

How many inverters do I need for solar panels? Typically, you only need one inverter for your solar panel system, but for larger setups, you ...

[Get a quote](#)



Solar Panel Sizes And Wattage , Sizing, Dimensions ...

The size or dimensions of the solar panels, measured in height by width, will



determine the number of solar panels that will fit on your roof and ...

[Get a quote](#)

How to Calculate Solar Panel, Battery, and Inverter Size

In general, your inverter capacity should be approximately the same size as the total wattage of your solar panels. This ensures that the inverter operates at its most efficient point, which is ...

[Get a quote](#)



Size your solar system

Talk to your solar retailer or installer about the inverter specifications for inverter to panel size requirements. If the system size (total rated solar panel output) is more than the inverter ...

[Get a quote](#)

Solar Inverter Sizing Guide for Maximum Efficiency

When choosing a solar inverter, size matters more than you might think. The right solar inverter sizing helps ensure

your system performs ...

[Get a quote](#)



How to Calculate Solar Panel, Battery, and Inverter Size

In general, your inverter capacity should be approximately the same size as the total wattage of your solar panels. This ensures that the inverter operates at ...

[Get a quote](#)

Solar inverter size: Calculate the right size for your ...

Inverters work most efficiently when operating near their maximum capacity and are typically sized to be roughly the same size as your solar panels. Inverters ...

[Get a quote](#)



Choosing the Right Home Inverter: The Ultimate Guide

A photovoltaic panel inverter, also known as a solar inverter or photovoltaic inverter connects solar panels to the



electrical grid or home devices. It changes the direct ...

[Get a quote](#)

How does sizing a solar inverter work?

Solar inverters come in all different sizes, big and small. Similar to solar panels, the size of an inverter can be rated in watts (W). When it comes ...

[Get a quote](#)



Contact Us

For catalog requests, pricing, or partnerships, please visit:
<https://www.zenius.co.za>